

# Sprockets for Standard Conveyor Chains

## Table of Dimensions

### Sprockets for HRS type Bushed Roller Chains

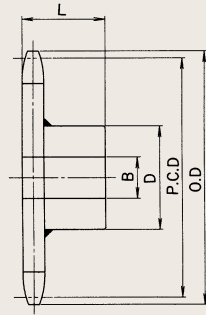

BW type

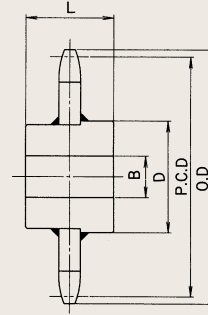

CW type

(mm)

Chain No.	Roller type	No. of Teeth N	Pitch Circle Dia. P.C.D.	Outer Dia. O.D.	BW type					CW type				
					Bore Dia. B		Hub		Mass (kg)	Bore Dia. B		Hub		Mass (kg)
					Pilot Bore	Maximum	Dia. D	Width L		Pilot Bore	Maximum	Dia. D	Width L	
HRS03075	R	6	150.0	171	26	40	65	52	2.9	26	40	70	55	3.4
		8	196.0	217		45	70	57	4.5		45	75	60	4.6
		10	242.7	264		50	75	62	5.9		50	85	70	6.9
		12	289.8	311		50	75	62	7.9		50	85	70	8.5
		14	337.0	358		55	85	67	10.7		55	90	75	11.2
	F	6	150.0	171		40	65	49	2.5		40	70	55	3.0
		8	196.0	217		45	70	54	3.4		45	75	60	4.1
		10	242.7	264		50	75	59	4.9		50	85	70	5.9
		12	289.8	311		50	75	59	6.5		50	85	70	7.1
		14	337.0	358		55	85	64	8.6		55	90	75	9.2
	S	6	150.0	161		40	65	52	2.9		40	70	55	3.4
		8	196.0	207		45	70	57	4.5		45	75	60	4.6
		10	242.7	254		50	75	62	5.9		50	85	70	6.9
		12	289.8	301		50	75	62	7.9		50	85	70	8.5
14		337.0	348	55	85	67	10.7	55	90	75	11.2			
HRS03100	R	6	200.0	221	26	45	70	57	4.4	26	45	75	60	4.8
		8	261.3	282		50	75	62	6.5		50	85	70	7.6
		10	323.6	345		50	75	62	9.4		50	85	70	10.1
		12	386.4	407		55	85	67	13.2		55	90	75	13.9
		14	449.4	470		55	90	72	17.7		60	100	80	18.5
	F	6	200.0	221		45	70	54	3.5		45	75	60	4.0
		8	261.3	282		50	75	59	5.4		50	85	70	6.6
		10	323.6	345		50	75	59	7.5		50	85	70	8.5
		12	386.4	407		55	85	64	11.0		55	90	75	12.1
		14	449.4	470		55	90	69	13.6		60	100	80	14.9
	S	6	200.0	211		45	70	57	4.4		45	75	60	4.4
		8	261.3	272		50	75	62	6.5		50	85	70	7.6
		10	323.6	335		50	75	62	9.4		50	85	70	10.1
		12	386.4	398		55	85	67	13.2		55	90	75	13.9
14		449.4	461	55	90	72	17.7	60	100	80	18.5			
HRS03150	R	6	300.0	321	26	50	75	62	8.1	26	50	85	70	8.7
		8	392.0	413		55	85	67	13.4		55	90	75	14.1
		10	485.4	506		55	85	67	19.7		55	90	75	20.1
		12	579.6	601		55	90	72	27.3		60	100	80	28.5
		14	674.1	695		65	100	77	37.0		70	110	90	38.8
	F	6	300.0	321		50	75	59	6.3		50	85	70	7.3
		8	392.0	413		55	85	64	10.5		55	90	75	11.3
		10	485.4	506		55	85	64	15.1		55	90	75	15.9
		12	579.6	601		55	90	69	21.1		60	100	80	22.5
		14	674.1	695		65	100	74	28.6		70	110	90	30.7
	S	6	300.0	311		50	75	62	8.1		50	85	70	8.7
		8	392.0	403		55	85	67	13.4		55	90	75	14.1
		10	485.4	497		55	85	67	19.7		55	90	75	20.1
		12	579.6	591		55	90	72	27.3		60	100	80	28.5
14		674.1	685	65	100	77	37.0	70	110	90	38.8			

※Tooth surfaces can be hardened, as specified.

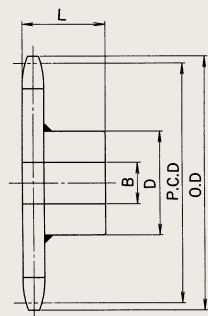

**BW type**

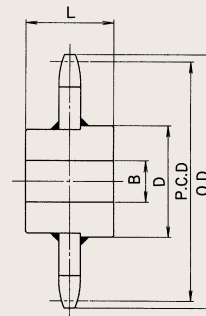

**CW type**

(mm)

Chain No.	Roller type	No. of Teeth N	Pitch Circle Dia. P.C.D.	Outer Dia. O.D.	BW type				CW type					
					Bore Dia. B		Hub		Mass (kg)	Bore Dia. B		Hub		Mass (kg)
					Pilot Bore	Maximum	Dia. D	Width L		Pilot Bore	Maximum	Dia. D	Width L	
HRS05075	R	8	196.0	224	30	60	90	76	6.4	30	60	100	80	7.6
		10	242.7	271		65	100	81	8.8		70	110	90	11.2
		12	289.8	318		65	100	81	11.8		70	110	90	13.1
		14	337.0	365		70	110	86	16.5		75	120	100	18.1
	F	8	196.0	224		60	90	72	5.4		60	100	80	6.6
		10	242.7	271		65	100	77	7.9		70	110	90	10.0
		12	289.8	318		65	100	77	9.8		70	110	90	11.1
		14	337.0	365		70	110	87	13.3		75	120	100	15.7
	S	8	196.0	212		60	90	76	6.4		60	100	80	7.6
		10	242.7	258		65	100	81	8.8		70	110	90	11.2
		12	289.8	305		65	100	81	11.8		70	110	90	13.1
		14	337.0	353		70	110	86	16.5		75	120	100	18.1
HRS05100	R	6	200.0	228	30	60	90	76	6.4	30	60	100	80	7.5
		8	261.3	289		65	100	81	10.1		70	110	90	12.1
		10	323.6	352		65	100	81	14.2		70	110	90	14.9
		12	386.4	414		70	110	91	19.9		75	120	100	22.1
		14	449.4	477		75	120	96	26.0		80	130	105	28.3
	F	6	200.0	228		60	90	72	5.8		60	100	80	7.0
		8	261.3	289		65	100	77	9.1		70	110	90	11.1
		10	323.6	352		65	100	77	12.0		70	110	90	13.2
		12	386.4	414		70	110	87	16.9		75	120	100	19.1
	S	6	200.0	216		60	90	76	6.4		60	100	80	7.5
		8	261.3	277		65	100	81	10.1		70	110	90	12.1
		10	323.6	339		65	100	81	14.2		70	110	90	14.9
12		386.4	402	70	110	91	19.9	75	120	100	22.1			
HRS05150	R	6	300.0	328	30	65	100	81	12.0	30	70	110	90	13.9
		8	392.0	420		70	110	91	19.8		75	120	100	21.9
		10	485.4	513		75	120	96	30.1		80	130	105	32.1
		12	579.6	608		80	130	101	41.2		90	140	115	44.1
		14	674.1	702		90	140	106	55.8		95	150	120	58.5
	F	6	300.0	328		65	100	77	11.0		70	110	90	12.1
		8	392.0	420		70	110	87	16.9		75	120	100	19.0
		10	485.4	513		75	120	92	24.1		80	130	105	26.9
		12	579.6	608		80	130	97	32.8		90	140	115	37.1
	S	6	300.0	316		65	100	81	12.0		70	110	90	13.9
		8	392.0	408		70	110	91	19.8		75	120	100	21.9
		10	485.4	501		75	120	96	30.1		80	130	105	32.1
12		579.6	595	80	130	101	41.2	90	140	115	44.1			
14	674.1	690	90	140	106	55.8	95	150	120	58.5				

※ Tooth surfaces can be hardened, as specified.

# Sprockets for Standard Conveyor Chains

## Sprockets for HR type Bushed Roller Chains

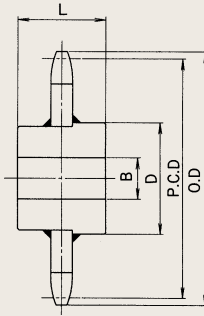

(mm)

Chain No.	No. of Teeth N	Pitch Circle Dia. P.C.D.	Outer Dia. O.D.			Bore Dia. B		Hub		Mass (kg)		
			R Roller type	F Roller type	S Roller type	Pilot Bore	Maximum	Dia. D	Width L	R Roller type	F Roller type	S Roller type
HR6608	8	173.2	-	-	189	30	70	110	70	-	-	7.2
	9	193.8	-	-	209		70	115	70	-	-	8.8
	10	214.5	-	-	230		70	115	70	-	-	10.0
	11	235.2	-	-	251		75	120	80	-	-	12.0
	12	256.0	-	-	272		75	120	80	-	-	14.0
	14	297.8	-	-	313		75	120	80	-	-	17.0
	16	339.7	-	-	355		75	120	80	-	-	19.6
	18	381.6	-	-	397		80	125	90	-	-	22.0
	20	423.6	-	-	439		80	125	90	-	-	24.0
	22	465.7	-	-	481		80	130	90	-	-	27.0
24	507.7	-	-	523	85	140	100	-	-	32.0		
30	634.0	-	-	650	40	95	150	100	-	-	45.0	
HR7813	8	204.1	-	-	226	30	70	115	80	-	-	10.5
	9	228.4	-	-	251		70	115	80	-	-	12.5
	10	252.8	-	-	275		75	120	80	-	-	15.0
	11	277.2	-	-	300		75	120	85	-	-	18.5
	12	301.8	-	-	324		75	120	85	-	-	20.5
	14	351.0	-	-	373		80	130	85	-	-	24.0
	16	400.4	-	-	423		85	140	100	-	-	30.0
	18	449.8	-	-	472		85	140	100	-	-	34.0
	20	449.3	-	-	522		85	140	100	-	-	41.0
	22	548.9	-	-	571		90	145	100	-	-	50.0
24	598.4	-	-	621	40	90	145	100	-	-	57.0	
30	747.3	-	-	770	40	90	145	100	-	-	78.0	
HR10007	6	200.0	207	207	215	30	70	115	70	7.0	6.7	6.7
	8	261.3	275	275	276		75	120	80	11.8	11.4	11.4
	9	292.4	308	308	307		75	120	80	14.0	13.5	13.5
	10	323.6	341	341	339		75	120	80	15.3	14.7	14.7
	11	355.0	374	374	370		80	125	80	17.7	17.0	17.1
	12	386.4	407	407	401		80	125	90	18.0	18.0	18.1
	14	449.4	472	472	464		80	130	90	22.4	21.6	21.7
	16	512.6	536	536	528		85	140	100	27.6	26.7	26.8
	18	575.9	601	601	591		85	140	100	32.3	31.3	31.4
20	639.3	665	665	654	40	95	150	100	38.4	37.2	37.8	
HR10105	6	203.2	230	-	217	40	60	95	65	5.5	-	6.2
	8	265.5	292	-	280		65	100	70	10.8	-	10.6
	9	297.1	324	-	311		65	100	70	14.2	-	12.3
	10	328.8	355	-	343		70	115	80	16.0	-	15.5
	11	360.6	387	-	375		70	115	80	17.2	-	16.2
	12	392.6	419	-	407		70	115	80	18.4	-	18.0
	14	456.6	483	-	471		75	120	85	21.5	-	22.2
	16	520.8	547	-	535		80	130	90	27.0	-	27.2
	18	585.1	612	-	599		80	130	90	30.0	-	30.5
20	649.5	676	-	664	80	130	90	36.5	-	35.0		

※Tooth surfaces can be hardened, as specified.

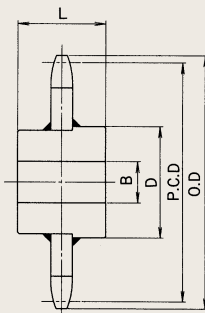

(mm)

Chain No.	No. of Teeth N	Pitch Circle Dia. P.C.D.	Outer Dia. O.D.			Bore Dia. B		Hub		Mass (kg)		
			R Roller type	F Roller type	S Roller type	Pilot Bore	Maximum	Dia D	Width L	R Roller type	F Roller type	S Roller type
HR10108	6	203.2	234	234	219	40	70	115	70	9.5	8.7	8.3
	8	265.5	297	297	281		75	120	80	14.8	14.0	13.8
	9	297.1	328	328	313		75	120	80	16.2	14.9	16.1
	10	328.8	360	360	344		75	120	80	20.0	18.0	18.1
	11	360.6	392	392	376		80	125	80	22.5	20.5	20.5
	12	392.6	424	424	408		80	125	90	25.4	23.4	22.0
	14	456.6	488	488	472		80	130	90	30.5	27.0	26.5
	16	520.8	552	552	536		85	140	100	33.5	31.5	33.5
	18	585.1	616	616	601		85	140	100	40.5	36.5	38.0
	20	649.5	681	681	665	95	150	100	49.0	40.0	45.0	
HR10113	6	203.2	234	-	225	40	75	120	85	11.0	-	9.1
	8	265.5	297	-	288		80	130	90	17.6	-	16.7
	9	297.1	328	-	319		80	130	90	21.6	-	20.0
	10	328.8	360	-	351		85	135	95	24.7	-	23.0
	11	360.6	392	-	383		90	145	100	31.5	-	27.5
	12	392.6	424	-	415		90	145	100	32.5	-	30.5
	14	456.6	488	-	479		95	150	105	36.5	-	36.0
	16	520.8	552	-	543		100	160	110	48.0	-	46.0
	18	585.1	616	-	607		105	165	115	55.5	-	52.5
	20	649.5	681	-	672	105	165	115	65.0	-	60.5	
HR15011	6	300.0	336	336	320	30	80	130	90	19.0	16.5	19.2
	8	392.0	428	428	412		90	145	100	31.5	26.5	32.0
	9	438.6	474	474	459	40	90	145	100	35.0	28.7	36.3
	10	485.4	521	521	506		95	150	105	39.5	30.0	40.5
	11	532.4	568	568	553		95	150	105	45.0	32.5	45.5
	12	579.6	615	615	600		100	160	110	52.5	38.5	53.0
	14	674.1	710	710	694	50	105	165	115	62.5	52.5	64.0
	16	768.9	804	804	789		105	170	120	76.0	69.5	78.1
HR15208	6	304.8	340	340	323	30	70	115	80	18.7	14.6	18.1
	8	398.2	434	434	416		75	120	85	26.0	22.1	27.4
	9	445.6	481	481	463		80	130	90	29.2	24.8	29.6
	10	493.2	529	529	511		85	135	95	35.0	30.0	37.0
	11	540.9	576	576	559		85	135	95	38.0	34.0	38.0
	12	588.8	624	624	607	40	90	145	100	43.0	38.0	43.0
	14	684.9	720	720	703		95	150	105	56.5	50.5	55.5
	16	781.2	817	817	799		95	150	105	64.5	63.5	64.5
HR15215	6	304.8	345	345	329	40	90	145	100	28.0	25.0	23.3
	8	398.2	438	438	423		95	150	105	36.0	32.0	36.5
	9	445.6	486	486	470		100	160	110	40.0	34.0	45.5
	10	493.2	533	533	518		100	160	110	44.0	37.0	51.0
	11	540.9	581	581	565		100	160	115	60.0	42.5	57.7
	12	588.8	629	629	613	50	105	170	120	64.0	56.5	67.5
	14	684.9	725	725	709		115	180	125	77.0	68.0	79.5
	16	781.2	821	821	806		115	185	130	93.0	81.0	92.5

※Tooth surfaces can be hardened, as specified.



# Sprockets for Standard Conveyor Chains

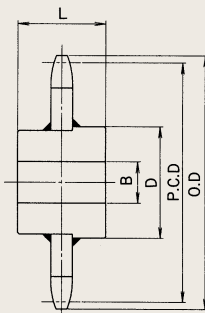

(mm)

Chain No.	No. of Teeth N	Pitch Circle Dia. P.C.D.	Outer Dia. O.D.			Bore Dia. B		Hub		Mass (kg)		
			R Roller type	F Roller type	S Roller type	Pilot Bore	Maximum	Dia. D	Width L	R Roller type	F Roller type	S Roller type
HR15219	6	304.8	354	354	333	40	95	150	105	26.0	—	25.0
	8	398.2	447	447	426	50	105	165	115	43.5	—	41.5
	9	445.6	495	—	473		105	165	115	49.5	—	50.5
	10	493.2	542	—	521		105	170	120	53.0	—	53.5
	11	540.9	590	—	569		115	180	125	61.0	—	59.5
	12	588.8	638	—	617		115	180	125	68.0	—	67.5
	14	684.9	734	—	713		115	185	130	82.0	—	79.5
16	781.2	830	—	809	125		200	140	103.0	—	100.0	
HR20015	6	400.0	446	446	424	40	95	150	105	37.5	31.5	36.5
	8	522.6	568	568	547	50	105	165	115	57.0	45.0	49.0
	9	584.8	630	630	609		105	165	115	65.0	50.0	58.5
	10	647.2	693	693	672		105	165	115	75.0	63.0	64.0
	11	709.9	755	755	734		115	180	125	85.0	74.0	74.0
	12	772.7	818	818	797		115	185	130	96.0	81.5	82.0
14	898.8	944	944	923	115		185	130	115.0	103.0	104.0	
HR20019	6	400.0	456	456	428	40	100	160	105	47.5	40.5	50.8
	8	522.6	579	579	550	50	100	160	105	73.5	64.0	72.5
	9	584.8	641	641	613		105	170	110	83.5	73.0	80.0
	10	647.2	703	703	675		105	170	110	89.5	80.5	90.0
	11	709.9	766	766	738		105	170	110	105.0	92.0	100.0
	12	772.7	829	829	801		115	180	115	114.0	110.0	111.0
14	898.8	955	955	927	115		180	115	125.0	128.0	137.0	
HR25015	6	500.0	546	546	524	40	100	160	110	51.0	44.0	56.0
	8	653.3	699	699	678	50	105	170	120	72.0	62.0	80.0
	9	731.0	776	776	755		115	180	125	94.0	72.0	91.0
	10	809.0	855	855	833		115	185	130	100.0	89.0	106.0
	11	887.4	933	933	912		115	185	130	121.0	100.0	122.0
12	965.9	1,011	1,011	990	120		190	135	136.0	111.0	143.0	
HR25019	6	500.0	556	556	528	50	105	170	120	67.0	60.0	70.0
	8	653.3	709	709	681		115	185	130	93.0	90.0	100.0
	9	731.0	787	787	759		120	195	135	111.0	110.0	119.0
	10	809.0	865	865	837		125	200	140	133.0	125.0	135.0
	11	887.4	943	943	915		130	210	150	149.0	140.0	154.0
	12	965.9	1,022	1,022	994		130	210	150	167.0	161.0	172.0
HR25026	6	500.0	—	—	531	50	120	190	135	—	—	84.0
	8	653.3	—	—	684		125	200	140	—	—	114.0
	9	731.0	—	—	762		125	200	140	—	—	122.0
	10	809.0	—	—	840		140	220	155	—	—	155.0
	11	887.4	—	—	919		140	225	160	—	—	173.0
	12	965.9	—	—	997		145	230	165	—	—	186.0
HR30019	6	600.0	656	656	628	50	115	180	125	89.0	79.0	90.0
	8	783.9	840	840	812		125	200	140	128.0	122.0	131.0
	9	877.1	933	933	905		125	200	140	145.0	136.0	147.0
	10	970.8	1,027	1,027	999		130	210	150	173.0	160.0	174.0

Notes: 1. In those sprockets for HR450XX HR600XX the outer diameter (O.D.) dimension may differ according to the method of use, so please inquire in advance.  
 2. Tooth surfaces can be hardened if specified.

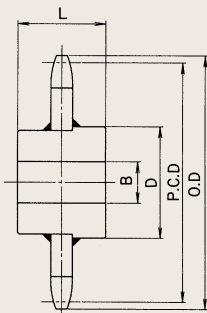

(mm)

Chain No.	No. of Teeth N	Pitch Circle Dia. P.C.D.	Outer Dia. O.D.			Bore Dia. B		Hub		Mass (kg)		
			R Roller type	F Roller type	S Roller type	Pilot Bore	Maximum	Dia. D	Width L	R Roller type	F Roller type	S Roller type
HR30026	6	600.0	670	670	631	50	125	200	140	108.0	92.0	108.0
	7	691.4	761	761	723	60	140	220	155	137.0	128.0	138.0
	8	783.9	854	854	815		140	220	155	160.0	137.0	166.0
	9	877.1	947	947	908		140	220	155	185.0	166.0	198.0
10	970.8	1,041	1,041	1,002	145		235	165	210.0	195.0	214.0	
HR30048	6	600.0	—	—	636	60	130	210	150	—	—	137.0
	7	691.4	—	—	727		140	220	150	—	—	165.0
	8	783.9	—	—	819		140	220	150	—	—	192.0
	9	877.1	—	—	913		145	230	160	—	—	224.0
	10	970.8	—	—	1,006		150	240	165	—	—	254.0
HR30054	6	600.0	—	—	640	60	140	220	160	—	—	154.0
	8	783.9	—	—	824		150	240	170	—	—	223.0
HR45026	6	900.0	970	970	931	50	125	200	150	187.0	162.0	188.0
	8	1,175.9	1,246	1,246	1,207		125	200	160	276.0	235.0	280.0
HR45048	6	900.0	988	988	936	60	140	220	160	218.0	177.0	222.0
	8	1,175.9	1,263	1,263	1,211		155	250	180	325.0	287.0	334.0
HR45054	6	900.0	998	998	940	60	145	230	165	246.0	208.0	256.0
	8	1,175.9	1,274	1,274	1,216		160	255	180	368.0	319.0	384.0
HR60048	6	1,200.0	1,288	1,288	1,236	60	160	255	180	347.0	297.0	368.0
	8	1,567.9	1,655	1,655	1,603		160	255	180	497.0	402.0	552.0
HR60054	6	1,200.0	1,298	1,298	1,240	70	175	280	195	399.0	356.0	438.0
	8	1,567.9	1,666	1,666	1,608		190	305	215	635.0	514.0	721.0

Notes: 1. In those sprockets for HR450XX HR600XX the outer diameter (O.D.) dimension may differ according to the method of use, so please inquire in advance.

2. Tooth surfaces can be hardened if specified.

# Sprockets for Standard Conveyor Chains

## Sprockets for HB type Bushed Chains

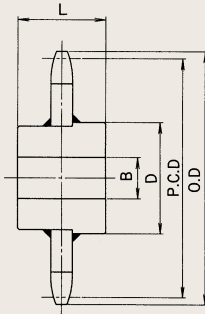

(mm)

Chain No.	No. of Teeth N	Pitch Circle Dia. P.C.D.	Outer Dia. O.D.	Bore Dia. B		Hub		Mass (kg)	Chain No.	No. of Teeth N	Pitch Circle Dia. P.C.D.	Outer Dia. O.D.	Bore Dia. B		Hub		Mass (kg)	
				Pilot Bore	Maximum	Dia. D	Width L						Pilot Bore	Maximum	Dia. D	Width L		
HB6608	8	173.2	189	30	70	110	70	7.2	HB10011	6	200.0	218	30	75	120	85	9.0	
	9	193.8	209		70	115	70	8.8		8	261.3	279		80	125	85	16.5	
	10	214.5	230		70	115	70	10.0		9	292.4	310		80	125	85	19.8	
	11	235.2	251		75	120	80	12.0		10	323.6	341		80	130	85	22.7	
	12	256.0	272		75	120	80	14.0		11	354.9	373		80	130	85	27.1	
	14	297.8	313		75	120	80	17.0		12	386.4	404		80	130	85	30.0	
	16	339.7	355		75	120	80	19.6		14	449.4	467		85	140	90	35.5	
	18	381.6	397		80	125	90	22.0		16	512.6	530		90	145	100	45.0	
	20	423.6	439		80	125	90	24.0		18	575.9	594		40	90	145	100	50.0
HB7811	8	204.1	226	30	70	115	80	10.5	HB15011	20	639.2	657	40	95	150	100	58.0	
	9	228.4	251		70	115	80	12.5		6	300.0	318		30	80	130	90	19.0
	10	252.8	275		75	120	80	15.0		8	392.0	410		40	90	145	100	31.7
	11	277.2	300		75	120	85	18.5		9	438.6	456			90	145	100	36.0
	12	301.8	324		75	120	85	20.5		10	485.4	503			95	150	105	40.1
	14	351.0	373		80	130	100	24.0		11	532.4	550		95	150	105	45.0	
	16	400.4	423		85	140	100	30.0		12	579.6	597		100	160	110	52.0	
	18	449.8	472		85	140	100	34.0		14	674.1	692		50	105	165	115	63.2
	20	499.3	522		85	140	100	41.0		16	768.9	787			105	170	120	75.3
HB10007	6	200.0	214	30	70	115	70	6.7										
	8	261.3	275		75	120	80	11.4										
	9	292.4	306		75	120	80	13.5										
	10	323.6	338		75	120	80	14.8										
	11	354.9	369		80	125	80	17.1										
	12	386.4	400		80	125	90	18.1										
	14	449.4	463		80	130	90	21.7										
	16	512.6	527		85	140	100	26.8										
	18	575.9	590		85	140	100	31.4										
	20	639.2	653	40	95	150	100	37.8										

※Tooth surfaces can be hardened if specified.