

Chains for Water Treatment Systems

Sprockets for Sludge Collector

Ductile cast iron (FCD600) was previously the standard material for sprockets, but corrosion and wear within sewage water wore them out faster than stainless steel chains, so that only the sprockets had to be changed.

We pursued research and improvement on the basis of our long experience, to develop our corrosion-resistant sprocket series (stainless steel assembled parts).

Stainless Sprockets

Stainless steel sprockets (SCS2) offer superior corrosion and wear resistance, minimizing the advance of wear and corrosion to extend sprocket lifespan. Use of stainless sprockets also realizes synergistic benefits between chains and sprockets, further extending wear life. Use of saver sprockets further reduces wear.

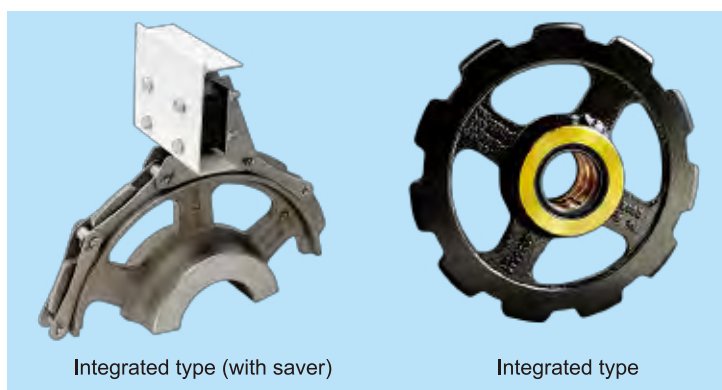

Integrated type (with saver)

Integrated type

Integrated Type

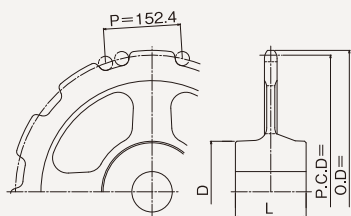

Integrated Type (saver)

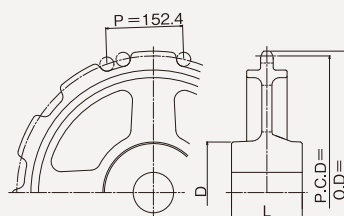

Split Type

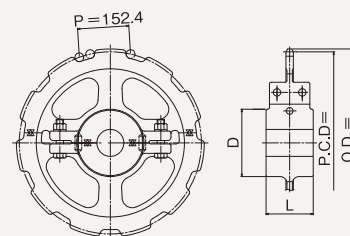

Chain No.	No. of teeth N	Pitch circle diameter P.C.D. (mm)	Outer diameter O.D. (mm)	Type	Shaft hole diameter B(mm)		Boss (mm)		Weight (kg)
					Pilot hole	Max.	Diameter D	Width L	
SAV15211-B	11	540.9	557	Integrated Type (saver)	80	125	200	140	53
	11	540.9	557	Split Type (saver)	80	125	200	140	58
SAV15206-B	11	540.9	565	Integrated Type (saver)	80	110	180	130	45
	11	540.9	565	Split Type	80	110	180	130	56
HSS15215-B	11	540.9	558	Integrated Type	80	125	200	140	48
HSS15210-B	11	540.9	558	Split Type	80	125	200	140	56
HSS15219-B	11	540.9	560	Integrated Type (saver)	80	125	200	140	63
SAV15215-B	11	540.9	560	Split Type (saver)	80	125	200	140	67
SAV715	11	540.9	560	Integrated Type	70	110	170	140	42
OSV15215-B	11	540.9	560	Integrated Type	90	125	200	140	48
OSV15219-B	11	540.9	560	Split Type	80	125	200	140	46
HSS15213-B	11	540.9	562	Integrated Type (saver)	110	150	230	130	63

Note: Sprockets can be painted for an additional fee.